

NORTHSIDE BOULEVARD INTERCHANGE

The Idaho Transportation Department is replacing the Northside Boulevard Interchange with a Single Point Urban interchange to accommodate more traffic and reduce delays.

Construction on Northside Boulevard will continue until early 2021.

WHAT TO EXPECT DURING CONSTRUCTION:

- > Lane closures will occur at night from 10 p.m. until 5 a.m. on week days and until 7 a.m. on weekends.
- > Traffic will be using the east side of Northside Boulevard as crews construct improvements on the west side.
- > Two rounds of 14-day closures will be necessary before the project is complete. More information to come.
- > Temporary traffic signals will be in place at the on and off-ramps of the interchange.
- > Work may be noisy at night due to backup alarms and large equipment.

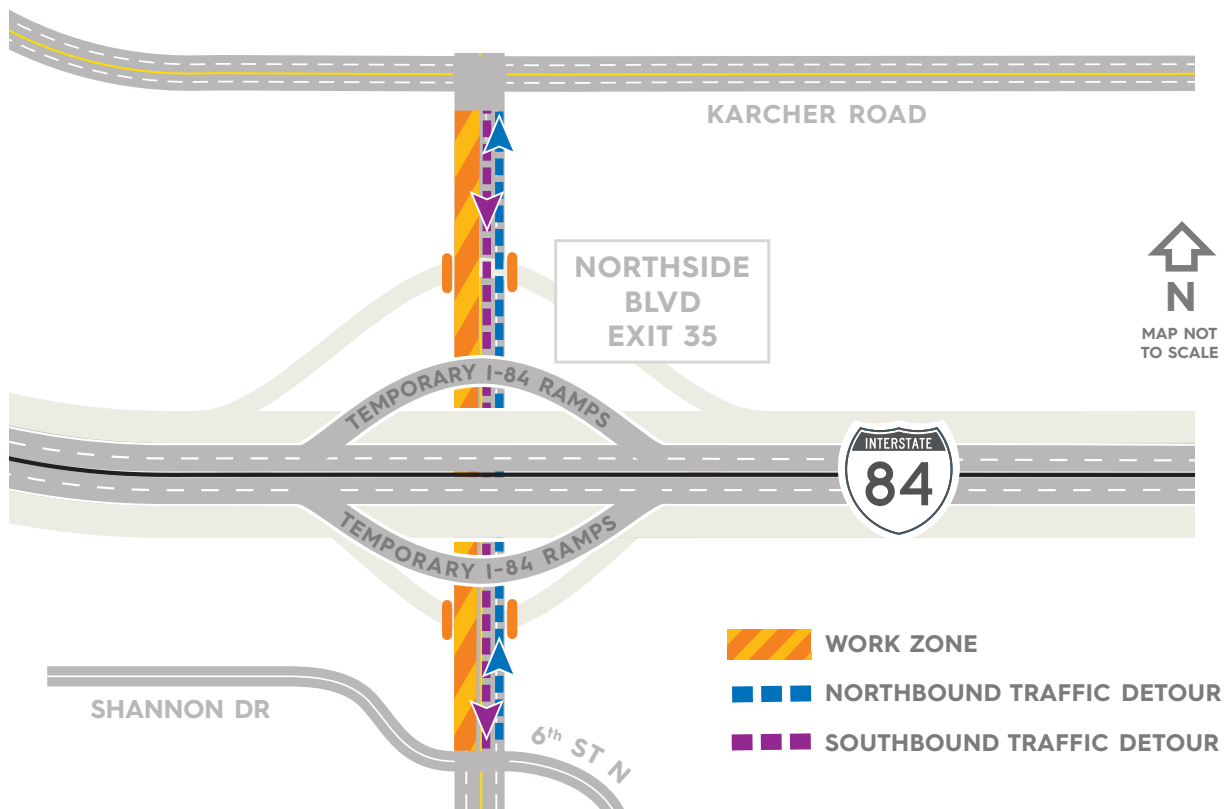

NOV 2020

SINGLE POINT URBAN INTERCHANGE (SPUI)

